

The information in this document may be subject to change pending final release

PREMIA ES

Pedestrian Power Pallet • AC Power
1.6 – 2.0 tonnes

PBP16N2
PBP18N2
PBP20N2

Exceptional performance... whatever the conditions

Developed for non-stop performance in the most challenging environments and the tightest spaces, PREMIA ES pedestrian power pallet trucks offer you a comprehensive range of transfer possibilities. Whether you are upgrading from a hand pallet truck, doing short shuttle work or looking for a truck prepared to go the distance, there is a PREMIA model which will meet your needs.

The 1.6 to 2.0 tonne N2 models have been specially created for hard-working applications. High stability and a market-leading lift height allow easy operation on uneven surfaces. Outdoor operation is possible in all weather thanks to protection of the chassis and electrical systems against rain and splashing water. Low-maintenance design, with no vulnerable components, minimizes the chance of breakdown and lowers servicing costs.

For extra versatility, N2 models give the operator a choice between two performance modes via the key switch. In all the models the state-of-the-art, simple-to-use tiller arm design protects hands and places everything within easy reach for safe, comfortable, controlled operation.

Frame and body

- **Robust construction** offers exceptional durability in all working conditions.
- **Sealed chassis** offers protection against dirt, dust and other particles to reduce wear (N2 models).
- **Water-resistant design** diverts splashed moisture away from key electrical components, for long truck life (N2 models).
- **High stability** is ensured by use of two linked castor wheels – next to the central drive wheel – in addition to the two load wheels.
- **Low centre of gravity** adds further stability, for secure operation.

Forks

- **Robust fork construction** with welded construction and rounded tips for effortless pallet entry, gives extra strength and durability.
- **Market-leading lift height** of 135 mm allows easy handling on steep ramps and loading docks, even with damaged pallets.



PREMIA^{ES}

Pedestrian Power Pallet

• AC Power 1.6 – 2.0 tonnes

Characteristics					
1.1	Manufacturer (abbreviation)			Mitsubishi	Mitsubishi
1.2	Manufacturer's model designation			PBP16N2	PBP18N2
1.3	Power source (battery, diesel, LP gas, petrol)			Battery	Battery
1.4	Operator type: pedestrian, (operator)-standing, -seated			Pedestrian	Pedestrian
1.5	Load capacity	Q	(kg)	1600	1800
1.6	Load centre distance	c	(mm)	600	600
1.8	Load wheel axle to fork face (forks lowered)	x	(mm)	960	960
1.9	Wheelbase	y	(mm)	1360	1424
Weight					
2.1	Truck weight with maximum battery weight		kg	431	502
2.2	Axle loadings with nominal load & maximum battery weight, drive/load side		kg	635 / 1396	806 / 1496
2.3	Axle loadings without load & with maximum battery weight, drive/load side		kg	332 / 99	381 / 121
Wheels, Drive Train					
3.1	Tires: PT=Power Thane, Vul=Vulkollan, drive/load side			Vul/Vul	Vul/Vul
3.2	Tire dimensions, drive side		(mm)	85x90	85x75
3.3	Tire dimensions, load side		(mm)	230x70	230x70
3.4	Castor wheel dimensions (diameter x width)		(mm)	100x40	100x40
3.5	Number of the wheels drive/load side (x=driven)			2+1x/2	2+1x/4
3.6	Track width (centre of tyres), drive side	b10	(mm)	480	480
3.7	Track width (centre of tyres), load side	b11	(mm)	355/375/495	355/375/495
Dimensions					
4.4	Lift height	h3	(mm)	135	135
4.8	Seat- or stand height		(mm)	-	-
4.9	Height of tiller arm / steering console (min./max.)	h14	(mm)	1050/1372	1050/1372
4.15	Fork height, fully lowered	h13	(mm)	85	85
4.19	Overall length, platform up/down	l1	(mm)	1648	1712
4.20	Length to fork face	l2	(mm)	498	562
4.21	Overall width	b1/b2	(mm)	720	720
4.22	Fork dimensions (thickness,width,length)	s/e/l	(mm)	55/165/1150	55/165/1150
4.25	Outside width over forks	b5	(mm)	520/540/660	520/540/660
4.32	Ground clearance, center of wheelbase (forks lowered)	m2	(mm)	30	30
4.33	Working aisle width (Ast) with 1000 x1200 mm pallet, load crosswise	Ast	(mm)	1694	1758
4.34	Working aisle width (Ast) with 800 x1200 mm pallet,load lengthwise	Ast	(mm)	1894	1958
4.35	Turning radius	Wa	(mm)	1454	1518
Performance					
5.1	Travel speed, with/without load		km/h	6.0/6.0	6.0/6.0
5.2	Lifting speed, with/without load		m/s	0.034/0.043	0.034/0.043
5.3	Lowering speed, with/without load		m/s	0.099/0.076	0.099/0.076
5.7	Gradeability, with/without load		%	10,0/20,0	10,0/20,0
5.10	Service brake (mechanical/hydraulic/electric/pneumatic)			Electric	Electric
Electric motors					
6.1	Drive motor capacity (60 min. short duty)		kW	1.0	1.0
6.2	Lift motor output at 15% duty factor		kW	0.8	0.8
6.4	Battery voltage/capacity at 5-hour discharge		V/Ah	24 / 150	24/250
6.5	Battery weight		kg	151	212
Miscellaneous					
8.1	Type of drive control			Stepless	Stepless
8.4 ¹⁾	Noise level, mean value at operator's ear (EN 12 053), drive/lift/idle		dB (A)	64/63/0	64/63/0
	Whole-body vibration (EN 13 059)		M/s ²	-	-
	Hand-arm vibration (EN 13 059)		M/s ²	< 2.5	< 2.5

Continuing improvement may lead to changes in these specifications

(1) Uncertainty of 4 dB(A) in section 8.04



Versatile battery compartment



Easy service access



Protective sealed chassis

	Mitsubishi
	PBP20N2
	Battery
	Pedestrian
	2000
	600
	960
	1424
	634
	864 / 1770
	475 / 159
	Vul/Vul
	85x75
	230x70
	100x40
	2+1x/4
	480
	355/375/495
	135
	-
	1050/1372
	85
	1712
	562
	720
	55/165/1150
	520/540/660
	30
	1758
	1958
	1518
	6.0/6.0
	0.039/0.06
	0.099/0.078
	10.0/20.0
	Electric
	1.0
	1.2
	24/250-375
	212-294
	Stepless
	64/76/0
	-
	< 2.5

PBP16/18/20N2

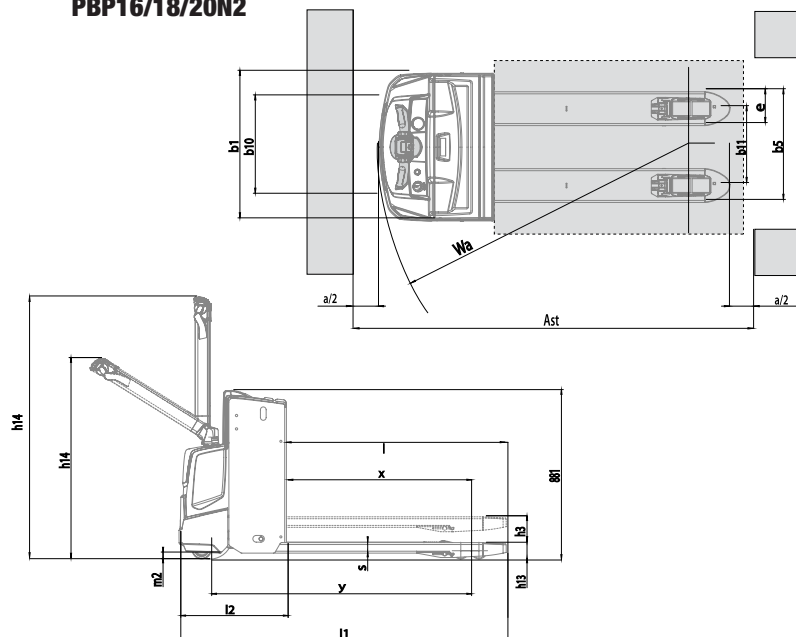

$$Ast = Wa - x + l6 + a$$

a = Safety clearance (200 mm)
l6 = Pallet length

PREMIA ES

THE NUMBER ONE

Number one for reliability... number one for productivity... whatever the conditions.

Compact, efficient and resilient, PREMIA powered pallet trucks meet every need.



Optional ergonomic levers



High lifting height



Quick-select performance modes

Drive

- **Powerful AC drive motor** is placed above the chassis plate, safeguarding it against the elements.
- **Oil-filled, sealed transmission** is shock-resistant, quiet and requires low maintenance over the long term.

Steering system

- **State-of-the-art tiller arm** offers the ultimate in ergonomic design, comfort and safety.
- **Small turning circle** together with compact chassis and excellent visibility means exceptional maneuverability.

Brakes

- **Regenerative braking** gives effective control, no brake wear and longer shift life.
- **Parking brake** is automatically activated, when necessary, for extra security on ramps.

Electrical and control systems

- **Programmable controller** adjusts brake acceleration, travel speed and braking to suit the application and operator – for greater versatility.
- **On-board diagnostics** and fault memory folder speed up servicing and help prevent damage.
- **High-efficiency electrical system** features waterproof components for maximum reliability – even in moist conditions.
- **Versatile battery compartment** accommodates DIN and BS size batteries with a variety of capacities for maximum compatibility with user's equipment needs.
- **Optional built-in charger** is water-resistant and is passively cooled for greater energy efficiency and longer battery life.

Operator environment and controls

- **Creep speed function and tiller arm lock bypass** maximize control in confined spaces.
- **Unique crossbar design** deflects obstacles away from tiller arm and operator's hand, protecting both truck and operator.
- **Choice of two performance modes** via key switch enhances energy efficiency and productivity.
- **Easy-to-operate controls** reduce operator fatigue and minimize mistakes to enhance safety.
- **Aluminium tiller arm shaft** is light but very strong.
- **Ergonomically shaped rubber hand grips** are comfortable and slip-free, allowing for easy reach of controls.
- **Battery discharge indicator** is fitted as standard for battery protection and monitoring of truck use.
- **Ground clearance** is only 35 mm – which makes foot trapping very unlikely.
- **Optional ergonomic levers** allow operators to raise and lower loads with ease – even when wearing gloves.
- **Optional multifunctional display** alerts operators and service engineers to potential problems – helping to avoid damage and encourage maintenance.

Other features

- **RapidAccess features** allow quick and easy entry to all areas for checks and maintenance.

Options include:

- **Choice of drive and load wheels for different applications**
- **Built-in charger**
- **Pallet entry and exit rollers**
- **Wide variety of fork dimensions**
- **Cold store modification (class III, -35°C)**
- **Load backrest**
- **Large lifting/lowering levers**
- **Multifunctional display with hour meter**
- **Equipment bar for mounting accessories**



when reliability is everything

Like any product bearing the Mitsubishi name, our materials handling equipment benefits from the huge resources and cutting-edge technology of one of the world's largest corporations. So when we promise you **quality, reliability** and **value for money**, you know we have the power to deliver.

Every model in our comprehensive, award-winning range of forklift trucks and warehouse equipment is built to high specifications and is designed to keep on working for you ... day after day... year after year... whatever the job... whatever the conditions.

To ensure your truck stays in constant productive action, we have a network of local dealers – hand-picked for their commitment to customer care... and backed up by the Mitsubishi Forklift Trucks organization. No matter where you are, we have a dealer close by – ready and willing to meet your needs.

That friendly local service covers everything from identifying the perfect model and configuration for your application to providing competitive, flexible finance and maintenance packages, unbeatable warranties, long and short term rental, and highly responsive field service and repairs... as well as the industry's quickest and most reliable parts supply.

Only Mitsubishi can give you this combination of global engineering excellence and outstanding local support... only Mitsubishi offers you such a quality product at such an affordable price... and only Mitsubishi places reliability as high as you do in its priorities. Contact your local dealer now and see what Mitsubishi can do for you.

You can find your nearest dealer at www.mit-lift.com



WESM 1438 (01/12)
Copyright © 2012. All rights reserved.

www.mit-lift.com

NOTE: Performance specifications may vary depending on standard manufacturing tolerances, vehicle condition, types of tyres, floor or surface conditions, applications or operating environment. Trucks may be shown with non-standard options. Specific performance requirements and locally available configurations should be discussed with your distributor of Mitsubishi forklift trucks. Mitsubishi follows a policy of continual product improvement. For this reason, some materials, options and specifications could change without notice.